

INSIGHT MAGNETIC GLASS | BOARDS

Modernize your space with a functional and contemporary image. Visionary magnetic glass boards provide the best of a quality whiteboard with smart style. Borderless and seamless, in gloss white or matte projection gray.

FEATURES / BENEFITS

- Tempered safety glass ideal for use in any environment
- Durable steel backing for magnetic surface
- Compatible with any dry/wet-erase marker, grease pen, etc
- Easily cleans without ghosting or staining
- Accepts rare earth magnets
- Concealed mounting devices for seamless appearance
- Includes glass accessory tray, set of magnets, markers, and eraser
- Fifty year limited warranty
- Has achieved GREENGUARD GOLD Certification

- Durable magnetic surface
- Industry-leading 50 year warranty
- Concealed mounting

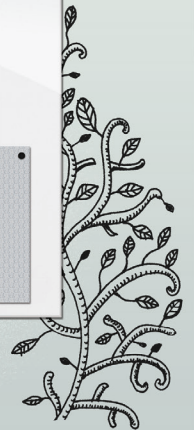
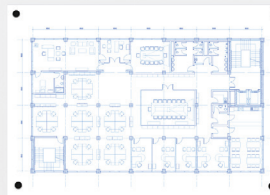

INSIGHT MAGNETIC GLASS | BOARDS

Exclusive design by VANERUM STELTER - subject to change

CONSTRUCTION

- Tempered safety glass with steel backing
- Concealed hanging system
- 50 year limited warranty
- Has achieved GREENGUARD GOLD Certification

ACCESSORIES

- Includes glass accessory tray
- Includes set of rare earth magnets, markers, and eraser

AVAILABLE OPTIONS

- Custom colors
- Also available as an enclosed cabinet

COLOR OPTIONS



Insight Board - Gloss White

| W | H | Base Number |
|----|----|-------------|
| 36 | 24 | CF83907 |
| 48 | 36 | CF83908 |
| 60 | 48 | CF83906 |
| 72 | 48 | CF83909 |
| 96 | 48 | CF83910 |

Insight Board - Matte Projection Gray

| W | H | Base Number |
|----|----|-------------|
| 48 | 48 | CF83849 |
| 60 | 48 | CF83851 |
| 72 | 48 | CF83850 |

Insight Board - Enclosed Cabinet

| W | H | Base Number |
|----|----|-------------|
| 48 | 36 | CF7382C |
| 72 | 48 | CF7382G |

