

ALIGN STORAGE

PRODUCT SPECIFICATONS





custom designed lockers with maple fronts and mesh inserts.



No matter what type of storage you need for your employees, patients or customers we have the solution. With our extensive Align portfolio, you can dress it up or dress it down... whatever you visualize, we can create it. And you'll love it. Is your style sophisticated? Inviting? Laid-back? Fun? The choice is truly yours!

Our unique set of components that make up the Align line can be configured into endless combinations, providing you with the ideal product for the specific application at hand. Easy installation, high utilization of space and flexible customization make Align your personal storage solution.



ALIGN

CONSTRUCTION SPECIFICATIONS

- Constructed of ¾" panels including a solid ¾" back panel
- All edges are finished
- Assembled using re-connectable, cam lock and stud hardware
- 8mm unglued dowels for proper alignment
- Doors are full overlay
- Standard adjustable shelves on concealed and locking shelf pins
- Available with 2" or 4" plinth base – notch or square

MATERIAL SPECIFICATIONS

- Standard 45lb. density particle board
- Doors fronts are covered with HPL laminate
- Melamine case standard, all laminate construction available
- All HPL laminate finishes Greenguard certified

HARDWARE SPECIFICATIONS

- Hinges are European style, concealed, adjustable with 120 degree opening
- Wire or arched pulls are available on all door fronts
- Levelers are included on continuous and integrated bases which are top adjustable through the bottom panel of cabinet
- Locks are available in both single and ganging lock configuration



Open Cabinets

Widths: 12", 16", 18", 20", 24", 27", 30", 32", 36"

Depths: 14", 20", 24"

Base Options: Separate Solid 2" Plinth or Integrated Base

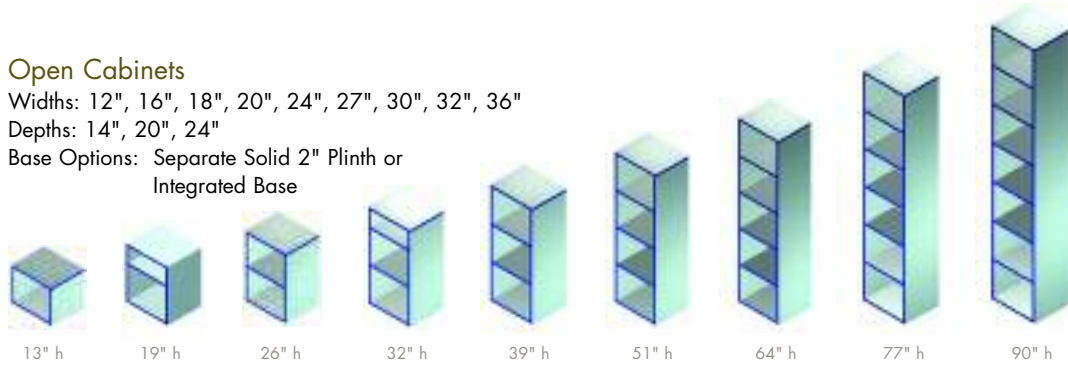

Open Corner Cabinets, Exterior

Widths: 14"

Depths: 14"

Base Options: Separate Solid 2" Plinth

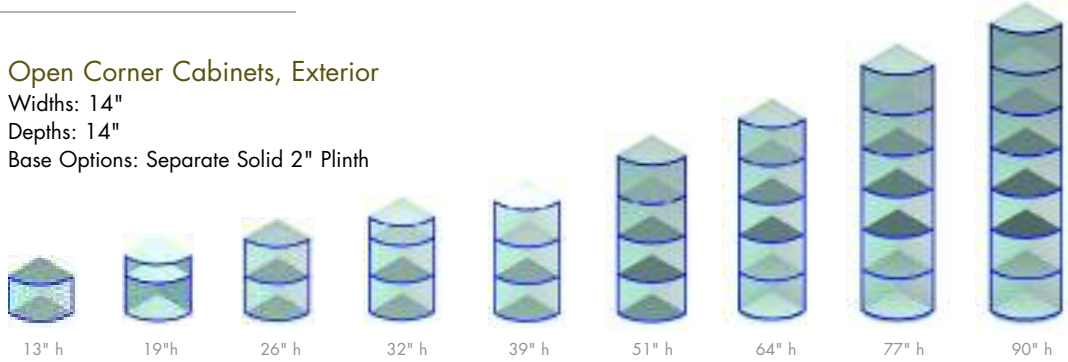

Open Corner Cabinets, Interior

Widths: 32"

Depths: 32"

Base Options: Separate Solid 2" Plinth

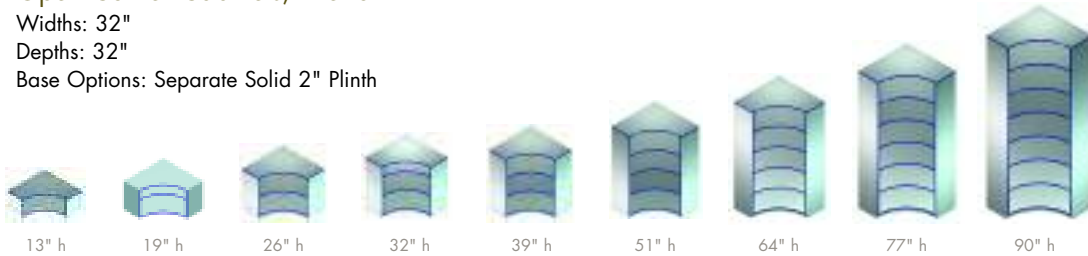

Base Cabinets, 30" Counter Height

Widths: 12", 16", 18", 20", 24", 27", 30", 32", 36"

Depths: 20", 24"

Base Options: Separate Solid 2" Plinth or Integrated Base



36" Counter Height & 34" Counter Height (ADA) Base Cabinets

Widths: 12", 16", 18", 20", 24", 27", 30", 32", 36"

Depths: 20", 24"

Base Options: Separate 4" Plinth or Continuous Base



Wall Cabinets

Widths: 12", 16", 18", 20", 24", 27", 30", 32", 36"
 Depth: 14"
 Heights: 13", 26", 32", 39"



Horizontal Organizers



Vertical Organizers



Open Wall Cabinet



Single Door



Double Door

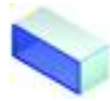

Office Wall

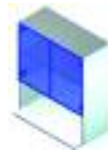

Microwave



Form Holder, Horizontal



Form Holder, Vertical



Mail Storage, Horizontal



Mail Storage, Vertical

Storage Cabinets, Lockers & Wardrobes

Widths: 12", 16", 18", 20", 24", 27", 30", 32", 36"
 Depths: 20", 24", 30"
 Heights: 51", 64", 77", 90"
 Base Options: Separate Solid 2" Plinth



Single Door



Double Door



Single Locker



Double Locker

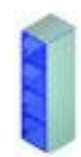

Quad Locker

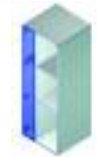

Wardrobe

Door Packs

Widths: 12", 16", 18", 20", 24", 27", 30", 32", 36"
 Heights: 13", 19", 26", 32", 39", 51", 64", 77", 90"
 Style: Base, Wall, Tall, Laminate Frame Glass and Metal Frame Glass



Base Cabinet Single



Wall Cabinet Single



Tall Cabinet Single



Base Cabinet Double



Wall Cabinet Double

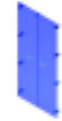

Tall Cabinet Double

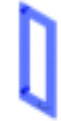

Laminate Frame Glass



Aluminum Frame Glass

Drawer Packs

Widths: 16", 18", 20", 24", 27", 30", 32", 36"

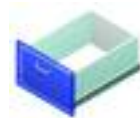

12" File Drawer Kit (1)

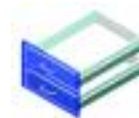

6" Drawer Kit (2)

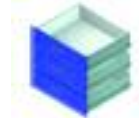

8" Drawer Kit (3)

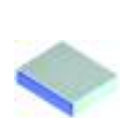

Pencil Drawer (1)

Finished End Panels, Shelves, Valances, & Plinths



Finished End Panels



Standard Shelves



Angled Wall Cabinet Shelves



Sliding Shelves



Valances



Solid 2" Plinth Base



Extended Corner 2" Plinth



Interior Corner 2" Plinth



Open locker w/ cubby



Storage Cabinet



4 Door Cubby

